

## Outline of Product

### <1> Cladding material

- **SOLIDO typeM\_LAP**

- SOLIDO typeM\_LAP (Length of exposed area: 182mm)  
Product No: SMG\*\*G t=5.5mm

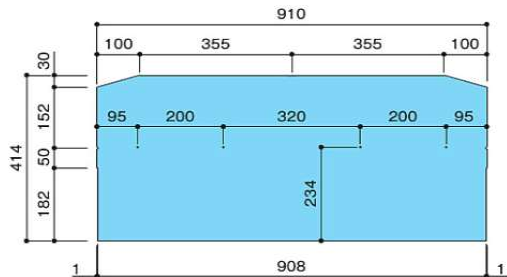

- G-Starter  
Product No: STG\*\*G t=5.2mm

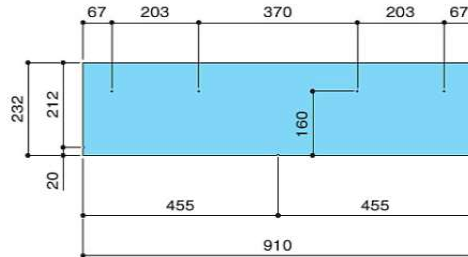

### <2> Installation Components

- For details of the part used, please refer to the Cross Section View

unit: mm

<p>Sill Sill flashing Product No: B238W*</p>	<p>Outside Metal outside corner Purchase locally</p>
<p>Inside</p>	
<p>Metal inside corner (metal finish) Purchase locally</p>	<p>Inside flashing (sealant finish) Product No: RCILK</p>
<p>Under eave Soffit flashing Product No: B254W*</p>	<p>Installation support tool Installation support pin for LAP-WALL Product No: KLGTS</p>

# Standard Installation Method

## Installation of LAP-WALL

### <1> Draw guide lines

- In order to install the panel horizontally, horizontal guide lines are drawn around the entire perimeter of the building.
- The position of the horizontal guide lines are shown in the table below.

Product	Item	Position of horizontal guide line	Calculation of horizontal guide line dimensions
SOLIDO typeM_LAP	For the starter	242mm from bottom of the rising edge of the sill flashing	Overall height of starter (232mm) + Gap between sill flashing and bottom of first panel (10mm)
	For the panel of first level	424mm from bottom of the rising edge of the sill flashing	Overall height of panel (414mm) + Gap between sill flashing and bottom of first panel (10mm)
	For the panel	Every 910mm from the guide line for the panel of first level	Length of exposed area for 5 panels (182mm×5)

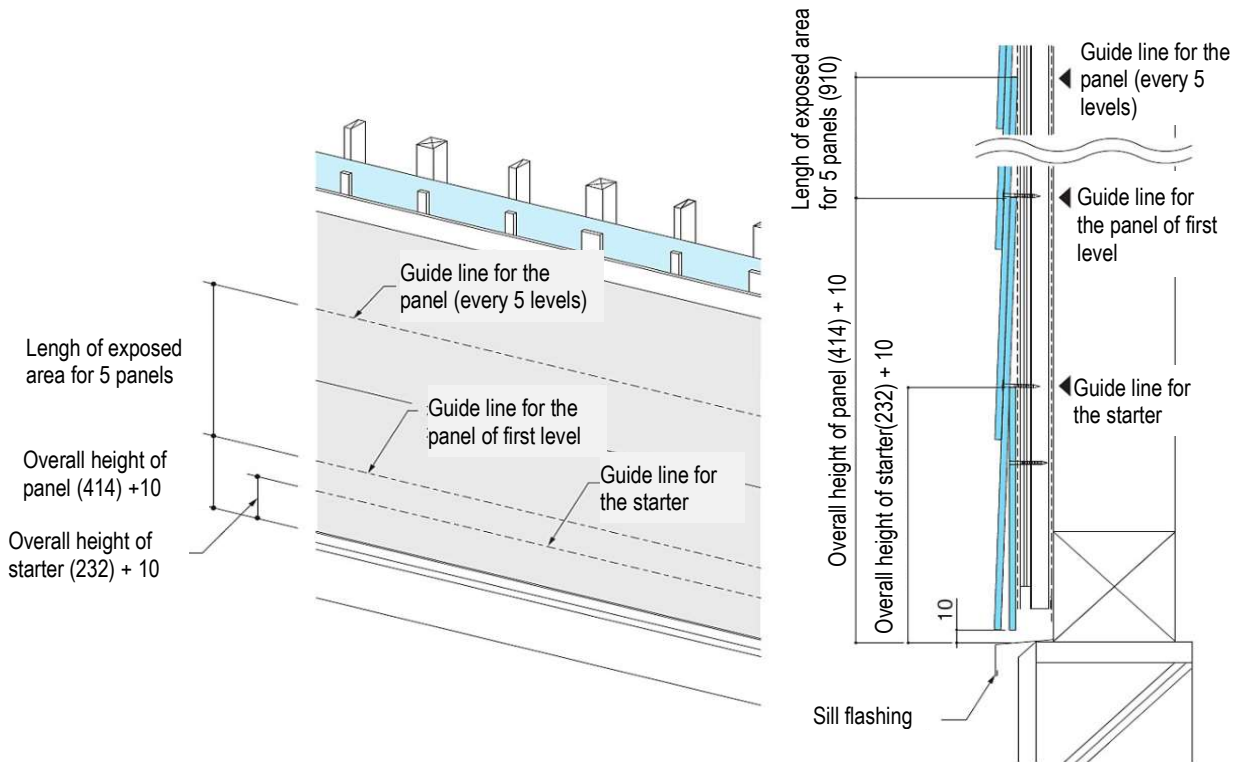

# Standard Installation Method

## Installation of LAP-WALL

### <2> Installation of starter and panel

- Panels should be installed about 20mm out from the bottom edge of the substrate for cladding with a gap of about 10mm from the sill flashing.
- After the starters are installed, the first level panels are aligned with the horizontal guide line for the first level and fasten with screws.
- The upper and lower panels are installed according to matching marks.
- For horizontal installation of panels, butt them together lightly.
- If the horizontal direction of wall is 15m or more, install with a gap 1.5mm at the horizontal butt joints of the panels.
- When drilling holes (approx.  $\phi 4$ mm) other than the existing holes in the panel to fasten the panel, secure a distance of at least 30mm from the edge of the panel.

- Installation specifications for panel are shown in the table below.

Product	Displacement width of upper and lower panels	Length of exposed area	Fastening specification	
			Number of fasteners	Fastening position
SOLIDO typeM_LAP	45mm (Half the full width of the panel)	182mm or less	4 per panels	4 hole positions in panel

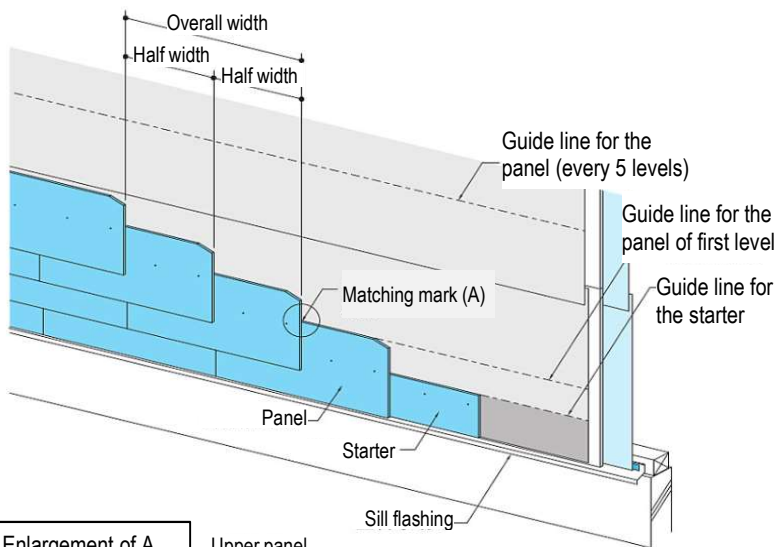

Enlargement of A  
How to match marks

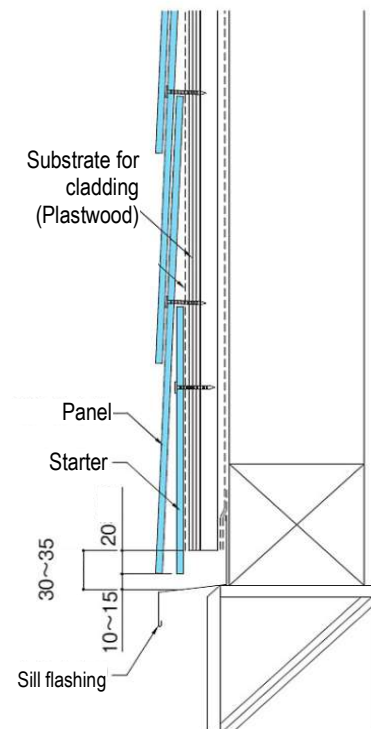
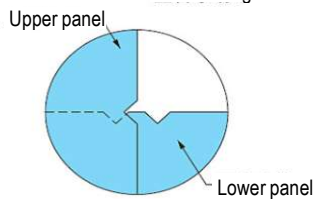

# Standard Installation Method

## Installation of LAP-WALL

### <3> Installation of horizontal edge

- Panels at the end of horizontal direction, such as outside/inside corners and opening sides, should be cut and installed with the dimension to the horizontal edge.
- Before installation, please consider and lay out the panels to avoid small width panels as much as possible.
- In case the existing holes cannot be used by cutting panel, drill holes (approx.  $\phi 4\text{mm}$ ) at a position where it does not hit the drainage part of the metal trim and fasten the panel.
- The drilling positions should be at least 30mm away from the edge of the panel.

※In the following cases, fasten with screws and adhesive.

- ① Top panels
- ② Panels with only one screw.
- ③ Panels that may fall or scatter.

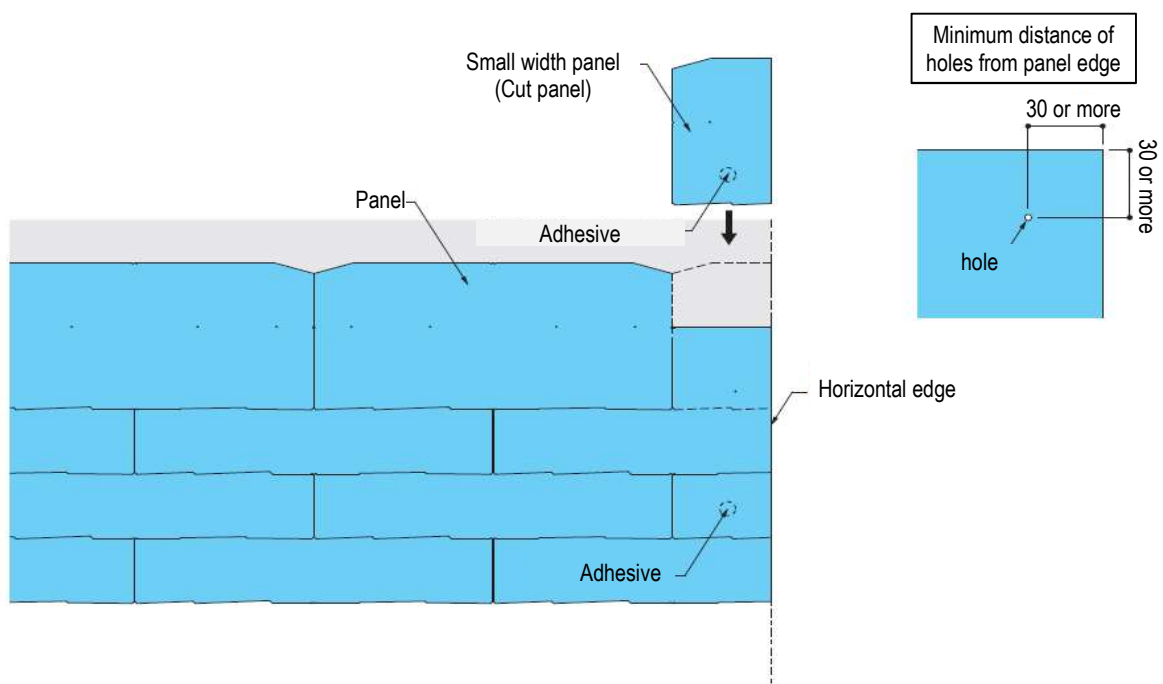

# Standard Installation Method

## Installation of LAP-WALL

### <4> Installation of top edge

- Panels at the top edge, such as under eaves, should be completely installed to the edge.
- For panels that beyond the edge of the installation area, cut off the top of the panel to match the edge of the installation area.
- If there is a gap between the panel cut at the top edge and the lower panel, install the panel scraps as a spacer to eliminate the gap.
- The top panels should be installed so that length is between 60mm and 182mm.
- The top panels should be fastened by drilling at least 3 pre-drilled holes (approx.  $\phi 4\text{mm}$ ) per panel and using adhesive together. If necessary, apply repair paint to screw heads.

※In the following cases, fasten with screws and adhesive.

- ① Top panels
- ② Panels with only one screw.
- ③ Panels that may fall or scatter.

The top panel (Length: between 60mm and 182mm)  
※Pre-drilled holes (approx.  $\phi 4\text{mm}$ ) and fasten with screws

Adhesive

※After screwing the lower panel, adhesive is applied to the screw positions and the upper panel is installed

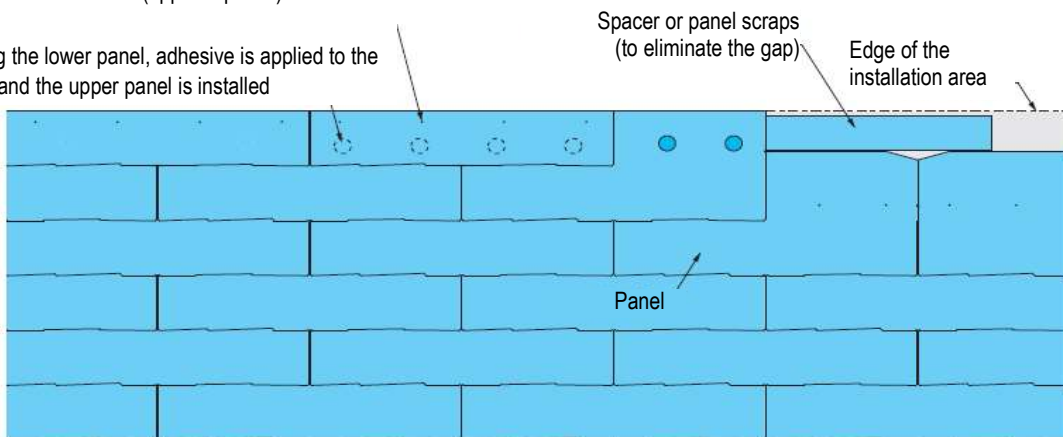

Exsample of cut at the top of panel

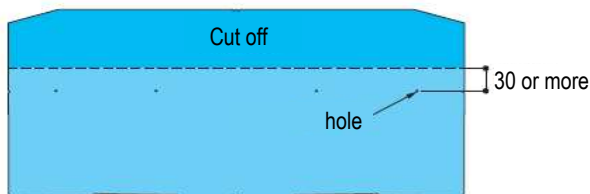

Minimum distance of holes from panel edge

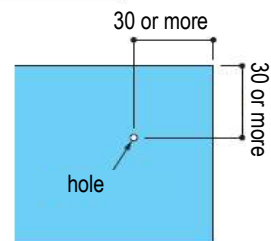

# Standard Installation Method

## Processing of panels

### <1> Cutting of panels

- For cutting the panels, It is recommended that using a cutting tool with a diamond blade for concrete with a vacuum attachment.  
※ If necessary, apply repair paint to the cut surfaces of the panel.
- If the width of the panel is less than 100mm, such as in L-shaped cut, cut and separate the panels, apply sealant along the cut surface of the panel, and install them butted together.

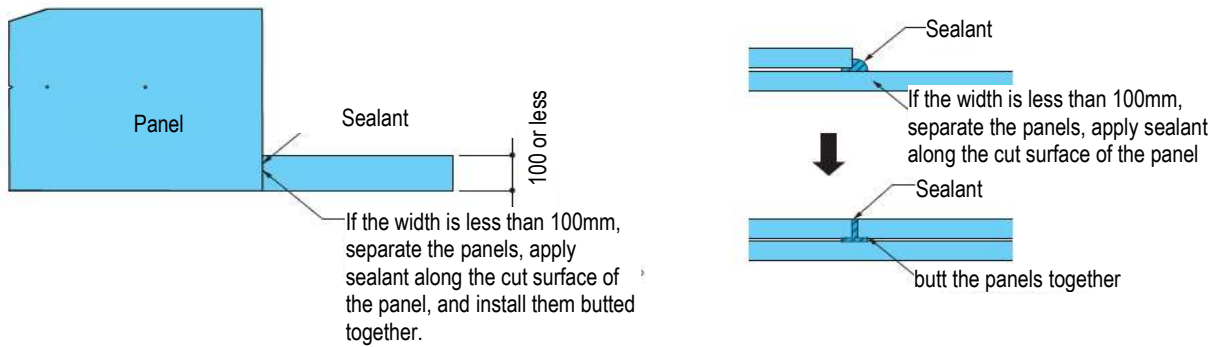

### <2> Precautions for drilling process

- To drill a circular hole in the panel, drill along the circumference, then make a cut in the center of the circle with a cutting tool and break it with a hammer or similar tool.
- ※ Since the panels are installed in layers, two to three panels need to be processed for each opening.

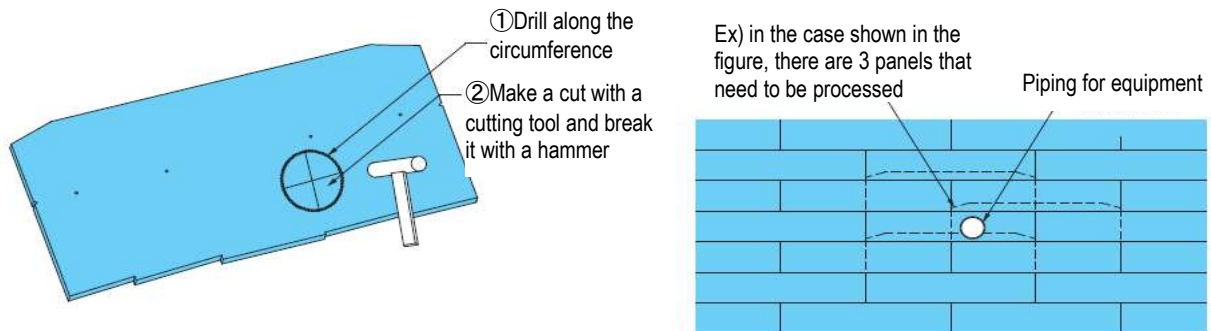

# Standard Installation Method

## How to use the installation support tool

### <1> Installation support pin for LAP-WALL

#### ① Applicable products

- All products of LAP-WALL

Installation support pin for LAP-WALL

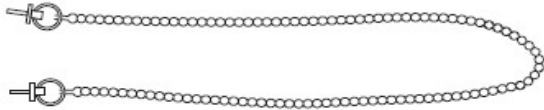

#### ② How to use

- Installation support pin for LAP-WALL is a tool used to assist in panel installation.
- By inserting pins into the screw holes in the panel, it can be temporarily placed on the top edge of the lower panel.

##### (1) Insert of pins

- Insert pins into the screw holes in the panel and temporarily place them on the top edge of the lower panels.  
[Pin insertion holes: 2 holes at both ends of panel]

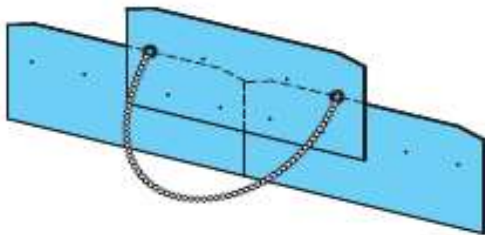

##### (2) Fastening of panels

- Determine the position of the panel to be fixed, and fasten with screws through the holes where the pins are not inserted.
- Once the panel is secured and positioned, remove the pin and fasten with screws in the remaining holes.

